



LONDON PARK LANE

InterContinental Meetings are designed to capture a genuine sense of place that will inspire delegates and get results. Our experienced team understands the demands of a busy event planner and ensure that the process runs seamlessly at every stage. Whatever the event, the InterContinental Meetings team is here to make life easier for you and to create a rewarding occasion for those attending.

INTERCONTINENTAL MEETINGS®



WELCOME TO NO. 1 PARK LANE

Situated at one of the Capital's most prestigious addresses, InterContinental London Park Lane presents modern luxury in the heart of Mayfair. Inspired by its location overlooking the Royal Parks, the hotel delivers elegant natural interiors and award-winning seasonal cuisine including Theo Randall at the InterContinental. The flagship property combines exemplary service with insider experiences that unlock London.

HOTEL FACILITIES

Located a stone's throw from Knightsbridge and Buckingham Palace, InterContinental London Park Lane offers the perfect base to explore the city.

A trip to the hotel would not be complete without visiting our signature restaurant; Theo Randall at the InterContinental. Celebrated Chef Randall carefully blends the best local ingredients with the finest Italian imports to create rustic Italian fare, which is regularly recognised as London's finest.

Overlooking the historic Wellington Arch, the hotel's Wellington Lounge offers a regal setting to enjoy Afternoon Tea. Watch the Royal Horse Guards pass by and enjoy Executive Chef Paul Bates' modern take on the quintessentially British tradition. Created with the best British ingredients and paired with bespoke teas, the menu was recently awarded the UK Tea Guild Award for Excellence.

The hotel's Cookbook Cafe shares this passion for the best of British ingredients and was recently awarded a coveted three-star award from the Sustainable Restaurant Association. The bountiful weekday market table is a local draw and the destination unlimited weekend brunch is celebrated as the 'best in London'.

Available exclusively to guests with permitted access, Club InterContinental is located on the seventh floor of the hotel and offers floor-to-ceiling windows overlooking the London skyline. The ultimate private haven, Club guests can enjoy all day refreshments, complimentary breakfast, afternoon tea, evening cocktails, Champagne and canapés.

Our in-house Spa InterContinental is a stylish retreat offering skincare and grooming services for men and women designed around any schedule.

SERVICE PROMISES

Our success is founded on delivering a seamless service in environments that inspire delegates to connect with their surroundings and each other. Whatever the event, the InterContinental Meetings team understands what it takes to make life easier for the planner and can create an efficient, memorable and highly-rewarding occasion.



HIGH STANDARDS

It's not just what we deliver that distinguishes us, but how we deliver it. From initial contact, our highly-trained team provides a responsive and personalised service, which ensures seamless communication from beginning to end. Busy event organisers are able to benefit from fast availability checks, transparent pricing and the latest technology tools, such as virtual tours and fully interactive floor plans that can be customised to each event.

INSIDER COLLECTION

As part of its meetings and events offering, InterContinental London Park Lane also features The Insider Collection. Drawing on the hotel's local knowledge The Insider Collection offers delegates the opportunity to book tailored meeting experiences such as team building activities and off-site meeting venues. Some of the Insider Collection features include:

INSIDER BREAKS

Insider Breaks are brief enlightening intermission, which give a taste of the local such as the hotel's award-winning English Counties menu and quintessentially British Afternoon Tea from Executive Chef Paul Bates.

INSIDER LOCATIONS

The team can organise meetings located offsite at local cultural landmarks and heritage locations, allowing delegates to experience a side of London that they would rarely see.

INSIDER INTERACTIONS

With London as our inspiration, we can create a team-building experience that will help connect your delegates. From a pasta making workshop with signature Chef Theo Randall to a guided art walking tour through Mayfair, discover an original way to engage delegates and motivate them to build effective working relationships.

INSIDER SPEAKERS

InterContinental London Park Lane offers access to well-known local speakers. From celebrities and cultural experts, our network of inspirational presenters enrich the overall meeting experience whilst bringing a sense of place.

INSIDER COMMUNITY



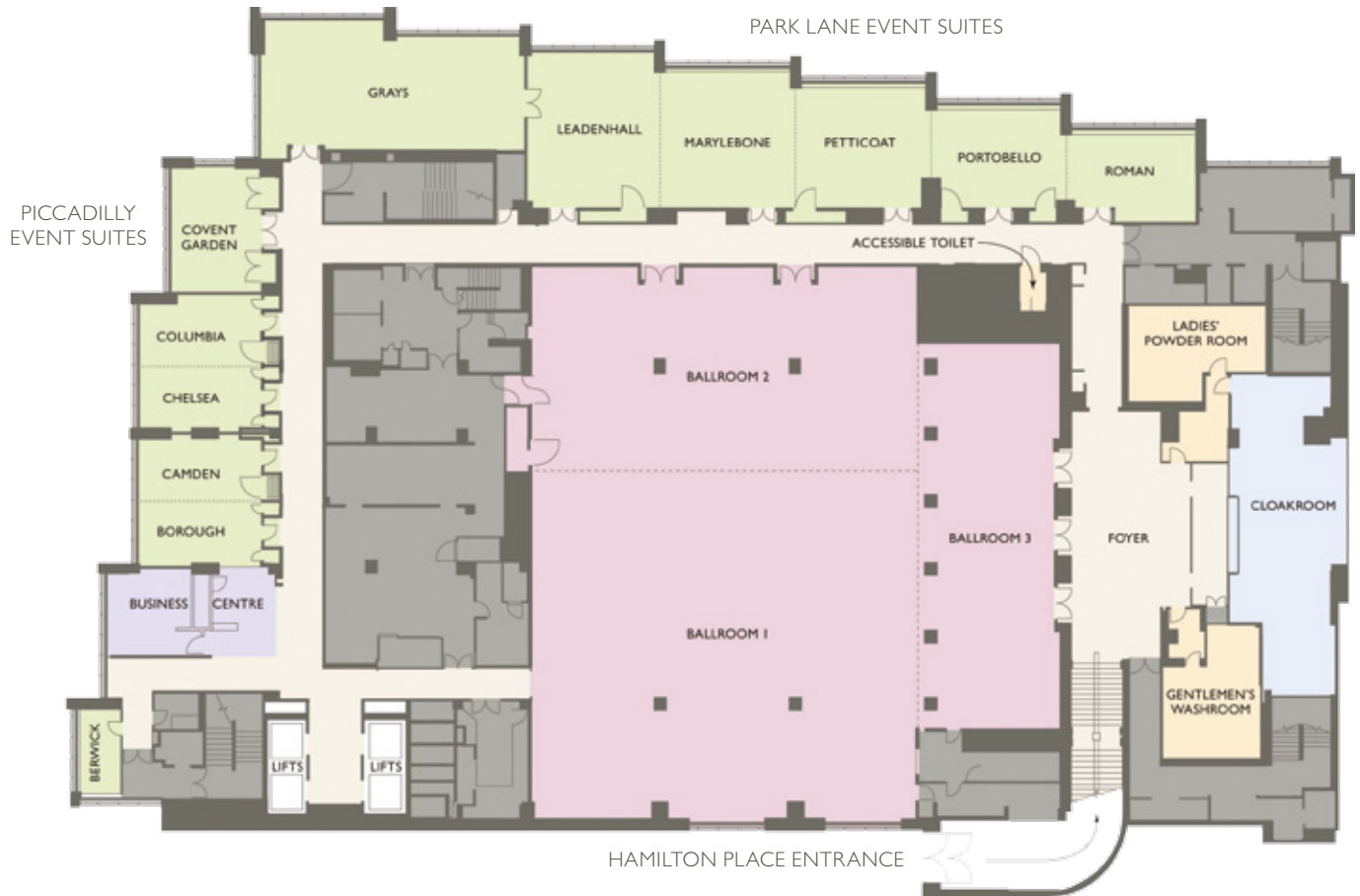





InterContinental London Park Lane gives delegates the opportunity to support the local community by volunteering with our partners.



MEETINGS AND EVENTS AT NO. 1 PARK LANE

The hotel's dedicated conference and events floor has been designed to deliver the optimum meeting environment and combines state-of-the-art facilities with expansive views over London.

The hotel is one of the most sought-after locations in the city for meetings, theatre-style conferences, and large-scale award ceremonies. The ballroom can accommodate up to 750 people for a gala dinner and 1000 for a drinks reception, while more intimate rooms, such as Berwick, Borough, Camden and Columbia (all named after famous London markets) are ideal for smaller meetings.

Name of Room	 Theatre Style	 Classroom Style	 Reception Style	 Banquet Style	 Boardroom Style	 Cabaret Style	 Area (sqm)	 Length x Width (m)	 Height (m)
Ballroom 1 + 2	700	330	1000	750	90	280	811	30.0 x 28.0	4.2
Ballroom 1	300	180	500	324	60	140	430	22.0 x 20.0	4.2
Ballroom 2	100	40	200	140	20	48	235	22.0 x 11.0	4.2
Ballroom 3	80	50	150	144	50	48	146	7.4 x 2.9	2.9

Park Lane Event Suites

1. Roman	20	–	30	20	14	–	36	7.2 x 4.9	2.6
2. Portobello	30	15	40	24	16	–	42	7.2 x 5.6	2.6
3. Petticoat	40	18	50	36	18	24	51	7.2 x 6.8	2.6
4. Marylebone	50	27	60	48	25	32	58	7.2 x 7.7	2.6
5. Leadenhall	50	27	70	48	25	32	64	7.2 x 8.6	2.6
6. Grays	80	72	100	72	38	48	101	12.7 x 6.2	2.7
Park Lane Suites Combined (1-6)	–	–	500	200	–	–	183	37.0 x 4.9	2.6

Piccadilly Event Suites

7. Covent Garden	–	–	–	–	12	–	31	6.5 x 4.8	2.7
8. Columbia	15	–	15	10	10	–	23	6.6 x 3.5	2.7
9. Chelsea	15	–	15	10	10	–	23	6.6 x 3.5	2.7
10. Columbia & Chelsea	30	–	40	36	20	–	46	6.6 x 7	2.7
11. Camden	15	–	15	10	10	–	24	6.8 x 3.5	2.7
12. Borough	15	–	15	10	10	–	24	6.8 x 3.5	2.7
13. Camden & Borough	30	–	40	36	20	–	48	6.8 x 7	2.7
14. Berwick	–	–	–	–	4	–	11	4.6 x 2.3	2.7

Capacities vary subject to client's usage of the room



 **INTERCONTINENTAL**
LONDON PARK LANE

InterContinental London Park Lane
One Hamilton Place, Park Lane, London W1J 7QY

Tel: +44 (0)20 7409 3131
events.london@ihg.com

parklane.intercontinental.com